

STEERING SYSTEM - POWER

Article Text

1992 Mitsubishi Mirage

For a a a a

Copyright © 1998 Mitchell Repair Information Company, LLC

Monday, April 01, 2002 10:17AM

ARTICLE BEGINNING

1992 STEERING

Chrysler Motors/Mitsubishi - Power Rack & Pinion

Dodge; Colt, Colt 200, Colt Vista, Stealth

Eagle; Summit, Summit Wagon

Mitsubishi; Diamante, Eclipse, Expo/Expo LRV, Galant,

Mirage, Precis, 3000GT

DESCRIPTION & OPERATION

NOTE: On some Diamante and Galant models, steering force is controlled electronically. See the article STEERING SYSTEM - ELECTRONIC POWER article in the STEERING section. On Galant, Stealth and 3000GT models with 4-Wheel Steering (4WS), a rear oil pump, flow control valve and power cylinder are included in power-assisted steering system.

Power-assisted rack and pinion steering system consists of a vane pump, flow control valve and an oil reservoir. Belt-driven vane pump supplies fluid through hoses to flow control valve. Flow control valve regulates fluid pressure to assist rack and pinion steering gear.

TROUBLE SHOOTING

Refer to TROUBLE SHOOTING - BASIC PROCEDURES article in the GENERAL TROUBLE SHOOTING section.

LUBRICATION

CAPACITY

On 4WS models, fluid capacity is approximately 1.6 qts. (1.5L). On all other models, fluid capacity is approximately .95 qts. (.9L).

FLUID TYPE

Use Dexron or Dexron-II ATF type fluid.

FLUID LEVEL CHECK

Start engine, and let it idle. Turn steering wheel several times to bring steering fluid to normal operating temperature. Turn steering wheel left and right several times while checking fluid for foaming and clouding. Fluid level should be between MIN and MAX marks on filler cap dipstick. Fill to MAX mark with Dexron or Dexron-II ATF.

HYDRAULIC SYSTEM BLEEDING

STEERING SYSTEM - POWER

Article Text (p. 2)

1992 Mitsubishi Mirage

For a a a a

Copyright © 1998 Mitchell Repair Information Company, LLC

Monday, April 01, 2002 10:17AM

CAUTION: DO NOT hold steering wheel to left or right lock for longer than 10 seconds, or oil pump damage may occur.
Use caution when bleeding system on 4WS models. All 4 wheels will be rotating during testing.

All Models

1) Disconnect coil high tension wire. Crank engine 10-15 seconds while turning steering wheel left and right. Connect coil high tension wire. Start engine, and let it idle. Turn steering wheel left and right until no air bubbles appear in oil reservoir.

2) Check fluid level, and ensure fluid is not milky. Turn steering wheel left and right, and ensure fluid level does not change. If fluid level changes more than .25" (6.3 mm) or if pump is noisy, fill with fluid to MAX mark on dipstick again. Repeat procedure until air bubbles are no longer present in fluid and fluid level stabilizes.

3) To bleed rear system on 4WS models, see 4WS (REAR SYSTEM).

4WS (Rear System)

1) Bleed air from power steering system. See ALL MODELS. Have an assistant enter vehicle. Raise and support vehicle. Start engine, and let it idle. Loosen bleed screw on left side of rear control valve, and install a bleed hose to bleed screw.

2) Have assistant turn steering wheel to full left position, and then immediately return wheel half way. Ensure air and fluid is discharged from hose. Repeat step several times. Ensure all air has been bled from system. Repeat step for right side bleed screw, turning steering wheel to full right position, and then immediately returning wheel half way.

3) Turn engine off. Loosen bleed screws on power cylinder. Install a bleed hose to power cylinder bleed screws. Have assistant start engine and run vehicle to 43-50 MPH to circulate fluid. Lower vehicle speed to 19-25 MPH, and maintain speed while turning steering wheel to full left and right positions.

4) When steering wheel is turned to full left or right positions, pressure will rise and air will circulate through bleed hose. Ensure air is discharged into oil reservoir. Repeat step several times until all air has been bled from system.

ADJUSTMENTS

POWER STEERING PUMP BELT

BELT ADJUSTMENT SPECIFICATIONS TABLE

Application	(1) Deflection: In. (mm)
Colt, Colt 200, Diamante (SOHC), Eclipse, Galant, Stealth (SOHC) & Summit	.2-.4 (5-10)
Colt Vista (2.4L), Diamante (DOHC), Expo, Precis & Summit Wagon (2.4L)	.3-.4 (8-10)
Colt Vista (1.8L), Expo LRV (With A/C),	

STEERING SYSTEM - POWER

Article Text (p. 3)

1992 Mitsubishi Mirage

For a a a a

Copyright © 1998 Mitchell Repair Information Company, LLC

Monday, April 01, 2002 10:17AM

Mirage (1.5L) & Summit Wagon (1.8L)2-.3 (5-8)
Expo LRV (Without A/C), Mirage (1.8L),
Stealth (DOHC) & 3000GT4-.5 (10-13)

(1) - With 22 lbs. (10 kg) pressure applied midway on longest
belt run.

PINION ROTATING FORCE

NOTE: Pinion rotating force procedure is performed with rack and
pinion assembly off vehicle and supported in soft-jawed vise.

Except Precis

Using an adapter and torque wrench, measure rotating force
while turning pinion gear through one complete rotation within 4-6
seconds. Refer to the PINION ROTATING FORCE SPECIFICATIONS and the
PINION ROTATING FORCE ADAPTER tables. If rotating force is not within
specification, adjust end plug (rack support cover), and recheck
rotating force. Tighten locking nut to 36-51 ft. lbs. (49-69 N.m).

Precis

Center rack, and attach end plug (rack support cover) to rack
housing. Tighten end plug to 96 INCH lbs. (11 N.m) using torque wrench
and adapter. Refer to the PINION ROTATING FORCE SPECIFICATIONS and
PINION ROTATING FORCE ADAPTER tables. Loosen end plug 30-60 degrees,
and tighten locking nut to 36-51 ft. lbs. (49-69 N.m).

PINION ROTATING FORCE SPECIFICATIONS TABLE

Application	INCH Lbs. (N.m)
Except Diamante & Mirage	5-11 (.6-1.3)
Diamante	11-16 (1.3-1.8)
Mirage	5-12 (.6-1.4)

PINION ROTATING FORCE ADAPTER

Application	Tool No.
Except Precis	CT-1108 Or MB991006
Precis	09565-11100

TESTING

HYDRAULIC SYSTEM PRESSURE TEST

CAUTION: DO NOT leave valve on pressure gauge closed longer than 10
seconds, or damage to oil pump will result.

STEERING SYSTEM - POWER

Article Text (p. 4)

1992 Mitsubishi Mirage

For a a a a

Copyright © 1998 Mitchell Repair Information Company, LLC

Monday, April 01, 2002 10:17AM

1) Disconnect pressure hose from oil pump. Install Pressure Gauge (MB990662-01). See Fig. 1. Bleed all air from system. See HYDRAULIC SYSTEM BLEEDING. Start engine, and let it idle. Turn steering wheel several times until temperature reaches 122°F (50°C). Set engine idle speed to 1000 RPM.

2) Close and open valve to measure oil pump pressure. Replace power steering pump if it is not within specification. Refer to the OIL PUMP PRESSURE SPECIFICATIONS table. Install pressure hose. Bleed system.

OIL PUMP PRESSURE SPECIFICATIONS TABLE

Application	psi (kg/cm ²)
Valve Closed	
Exc. Colt, Colt 200, Mirage, Precis & Summit ...	1067-1166 (75-82)
Colt, Colt 200 & Summit	782-881 (55-62)
Mirage	1351-1451 (95-102)
Precis	853 (60)
Valve Open (All Models)	114-142 (8-10)

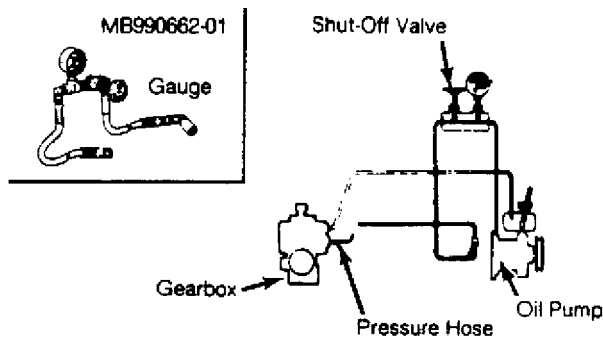

Fig. 1: Connecting Pressure Gauge & Shutoff Valve
Courtesy of Mitsubishi Motor Sales of America

STEERING WHEEL TURNING FORCE

Place vehicle on level surface with steering wheel in straight-ahead position. Attach a spring scale to steering wheel. With engine running at idle, measure turning force by turning steering wheel left and right within a range of 1 1/2 turns.

STEERING WHEEL TURNING FORCE TABLE

Application	Lbs. (kg)
Except Diamante & Precis	8 (3.6)
Diamante	7 (3.2)
Precis	9 (4.1)

REMOVAL & INSTALLATION

STEERING SYSTEM - POWER

Article Text (p. 5)

1992 Mitsubishi Mirage

For a a a a

Copyright © 1998 Mitchell Repair Information Company, LLC

Monday, April 01, 2002 10:17AM

* PLEASE READ THIS FIRST *

WARNING: On Diamante, Stealth and 3000GT models, before doing any repairs, disconnect and shield battery ground. Disconnect SRS connector at control unit. Use caution when working around steering column (air bag could deploy).

POWER STEERING PUMP

Removal & Installation

Disconnect pressure and suction hoses from pump. Drain fluid into container. Remove oil pump mounting bolts, belt and oil pump. Remove reservoir hoses and retaining bolts. Remove reservoir. To install, reverse removal procedure. Fill and bleed system.

POWER RACK & PINION

Removal & Installation (Colt, Colt 200, Mirage & Summit)

1) Raise and support vehicle. Pull back dust shield (if equipped), and remove coupling bolt from pinion shaft joint. Disconnect hydraulic lines from steering gear, and remove "O" rings. Drain fluid.

2) Remove tie rod end cotter pins and nuts. Using Puller (MB991113), separate tie rod ends from steering knuckles. Remove rack housing mounting clamp assemblies. Remove power rack and pinion assembly. To install, reverse removal procedure. Fill and bleed system. Check wheel alignment.

Removal & Installation (Diamante, Stealth & 3000GT)

1) Raise and support vehicle. Remove coupling bolt from pinion shaft joint. Remove hydraulic lines from steering gear. Drain fluid. Remove tie rod end cotter pins and nuts. Using Puller (MB991113), separate tie rods from steering knuckles. Remove left and right crossmember.

2) Remove exhaust pipe mounting nuts and lower pipe. On 4WD vehicles, remove bolts from transfer assembly, and remove transfer assembly from transaxle. Remove and support drive shaft from transfer assembly. Remove stabilizer bar (if necessary).

3) Remove power rack and pinion assembly by moving assembly completely to right and off crossmember. Tilt power rack and pinion assembly downward, and remove from left side.

4) To install, reverse removal procedure. Fill and bleed system. Check wheel alignment.

Removal & Installation (Eclipse & Galant)

1) Raise and support vehicle. Remove coupling bolt from pinion shaft joint. Remove hydraulic lines from steering gear. Drain fluid. On Galant with electronic power steering, disconnect solenoid valve connector. See Fig. 5.

2) Remove tie rod end cotter pins and nuts. Using Puller (MB991113), separate tie rods from steering knuckles. Remove rear

STEERING SYSTEM - POWER

Article Text (p. 6)

1992 Mitsubishi Mirage

For a a a a

Copyright © 1998 Mitchell Repair Information Company, LLC

Monday, April 01, 2002 10:17AM

mounting bolts from center crossmember. Remove long bolt from engine mount attached to center crossmember.

3) Remove exhaust pipe mounting nuts and lower pipe. On 4WD models, remove bolts, and remove transfer assembly from transaxle. Remove and support drive shaft from transfer assembly. Remove stabilizer bar (if necessary).

4) Remove rack housing mounting clamp assemblies. Remove rack and pinion assembly by moving assembly completely to right and off crossmember. Tilt power rack and pinion assembly downward, and remove from left side.

5) To install, reverse removal procedure. Fill and bleed system. Check wheel alignment.

Removal & Installation (Colt Vista, Expo & Summit Wagon)

1) Raise and support vehicle. Remove dust shield bolts. Remove coupling bolt from pinion shaft joint. Disconnect hydraulic lines from steering gear. Drain fluid.

2) Remove tie rod end cotter pins and nuts. Using a tie rod puller, separate tie rod ends from steering knuckles. Remove rear mounting bolts from center crossmember. Remove long bolt from engine mount attached to center crossmember.

3) On 2WD models, remove stabilizer bar. On 4WD models, remove crossmember support bracket, located on left side of transaxle. See Fig. 2. On all models, remove rack housing mounting clamp assemblies. Remove power rack and pinion assembly.

4) To install, reverse removal procedure. Fill and bleed system. Check wheel alignment.

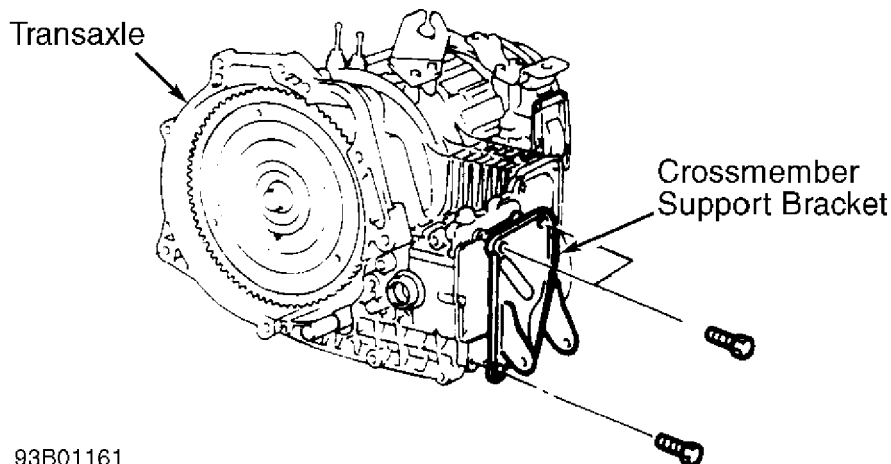

93B01161

Fig. 2: Removing Crossmember Support Bracket (4WD)
Courtesy of Chrysler Motors

Removal & Installation (Precis)

1) From inside vehicle, remove coupling bolt from pinion shaft joint. Raise and support vehicle. Remove tie rod end cotter pins and nuts. Using Puller (09568-31000), separate tie rods from steering knuckles.

2) Disconnect hydraulic lines from steering gear. Drain fluid. Remove clamp from pinion shaft dust shield. Remove rack housing

STEERING SYSTEM - POWER

Article Text (p. 7)

1992 Mitsubishi Mirage

For a a a a

Copyright © 1998 Mitchell Repair Information Company, LLC

Monday, April 01, 2002 10:17AM

mounting clamp assemblies. Remove power rack and pinion assembly toward right side of vehicle.

3) To install, reverse removal procedure. Fill and bleed system. Check wheel alignment.

REAR OIL PUMP

Removal & Installation (4WS)

1) Raise and support vehicle. Remove muffler. Support differential case using transmission jack. Remove rear strut assembly lower mounting bolts. Remove crossmember brackets at front of suspension.

2) Remove crossmember mounting nuts on differential (rear) side of suspension. Disconnect pressure and suction hoses from rear oil pump. Drain fluid. Slightly lower rear suspension. Remove rear oil pump. To install, reverse removal procedure. Fill and bleed system.

POWER CYLINDER

Removal & Installation (4WS)

1) Raise and support vehicle. Remove muffler. Support differential case using transmission jack. Remove rear strut assembly lower mounting bolts. Remove crossmember brackets at front of suspension.

2) Remove crossmember mounting nuts on differential (rear) side of suspension. Disconnect pressure hoses and "O" rings from power cylinder. Drain fluid. Slightly lower rear suspension. Remove tie rod nuts and power cylinder mounting bracket bolts. Remove power cylinder. To install, reverse removal procedure. Fill and bleed system. Check wheel alignment.

OVERHAUL

POWER STEERING PUMP

Disassembly

1) Remove pump rear cover, cam ring, "O" rings and vanes from rotor. See Fig. 3. Remove snap ring from pulley assembly. Remove rotor.

2) Tap pulley assembly using plastic hammer to remove it from pump body. Remove suction connector and oil seal from pump body. Remove connector, flow control valve and spring from pump body.

STEERING SYSTEM - POWER

Article Text (p. 8)

1992 Mitsubishi Mirage

For a a a a

Copyright © 1998 Mitchell Repair Information Company, LLC

Monday, April 01, 2002 10:17AM

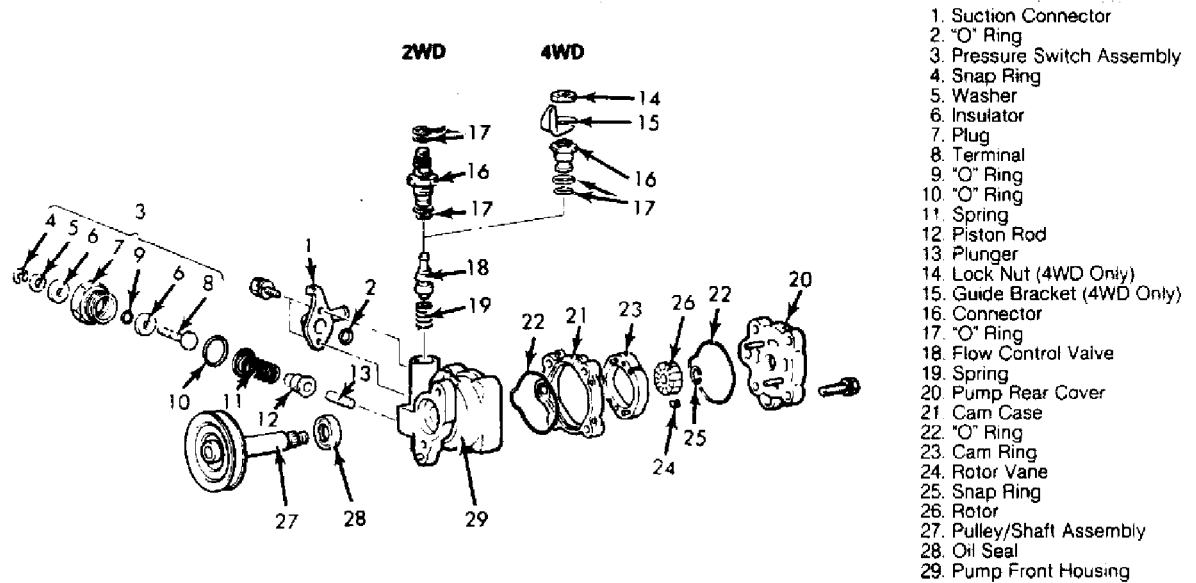

Fig. 3: Exploded View Of Power Steering Pump (Typical)
Courtesy of Mitsubishi Motor Sales of America

Inspection

Check pulley assembly, cam ring, rotor and vanes for wear. Check pump cover and pump body for abrasion. Check flow control valve for clogging.

Reassembly

Apply Dexron-II ATF fluid to "O" rings and vanes. To reassemble, reverse disassembly procedure. Install oil seal into pump body using Installers (MB990925-01 and MB990938-01). Install vanes into rotor in right direction. See Fig. 4.

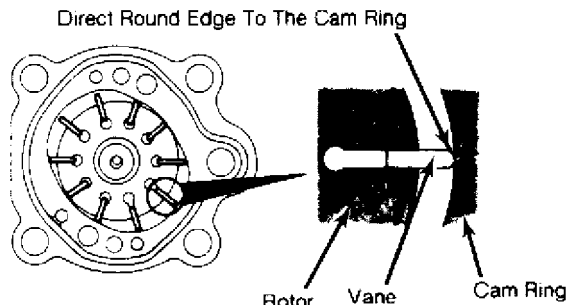

Fig. 4: Installing Vanes Into Rotor Of Power Steering Pump
Courtesy of Mitsubishi Motor Sales of America

POWER RACK & PINION

NOTE: Some Diamante and Galant models are equipped with Electronic Power Steering. For exploded view of electronic power rack and pinion assembly, see Fig. 5.

Disassembly (Except Diamante & Galant With Electronic

STEERING SYSTEM - POWER

Article Text (p. 9)

1992 Mitsubishi Mirage

For a a a a

Copyright © 1998 Mitchell Repair Information Company, LLC

Monday, April 01, 2002 10:17AM

Power Steering)

1) With power rack and pinion assembly mounted in soft-jawed vise, remove tie rod ends, boot clamps and boots. See Fig. 6. Using a chisel, remove tie rod tab washer. Remove tie rod assemblies.

2) Remove adjusting plug lock nut. Using Socket (MB990607-A), remove rack support cover. Remove rack support spring and rack support. Remove bolts at valve housing, and remove valve housing. Remove oil seals and pinion valve assembly. Turn rack stopper clockwise to align circlip with slot in gear housing for removal.

3) When circlip comes out of housing, turn rack stopper counterclockwise to remove circlip. Remove rack stopper, rack bushing and rack from rack housing. Remove "O" ring and oil seal from rack bushing.

4) Use brass drift to remove ball bearing, needle bearing and oil seal from pinion side of rack housing. Use pipe to remove back-up washer and oil seal from rear of rack housing. Using a screwdriver, remove resin ring from pinion valve assembly.

Inspection

Check bearings, rack bushing and rack teeth for damage and wear. Check pinion valve assembly for damage to teeth and wear to bearing. Replace all oil seals and "O" rings.

Reassembly

1) Apply Dexron-II ATF fluid to all "O" rings. Lubricate rack teeth, bearings and teeth on pinion valve assembly with multipurpose grease. Reassemble rack in reverse order of disassembly.

2) Using Drivers (MB991097 and MB9901098), install back-up washer and oil seal in rack housing. Using Drivers (MB991100 and MB991102), install needle bearing in rack housing. Using Socket (MB990607-A), install adjusting plug.

3) Install rack support spring, rack support cover and rack support. Install adjusting plug lock nut. Using Driver (MB99100), install pinion oil seal in rack housing. Using Drivers (C-4637-1 and MB990927), install "O" ring into rack bushing. Adjust pinion rotating force. See PINION ROTATING FORCE under ADJUSTMENTS.

STEERING SYSTEM - POWER

Article Text (p. 10)

1992 Mitsubishi Mirage

For a a a a

Copyright © 1998 Mitchell Repair Information Company, LLC

Monday, April 01, 2002 10:17AM

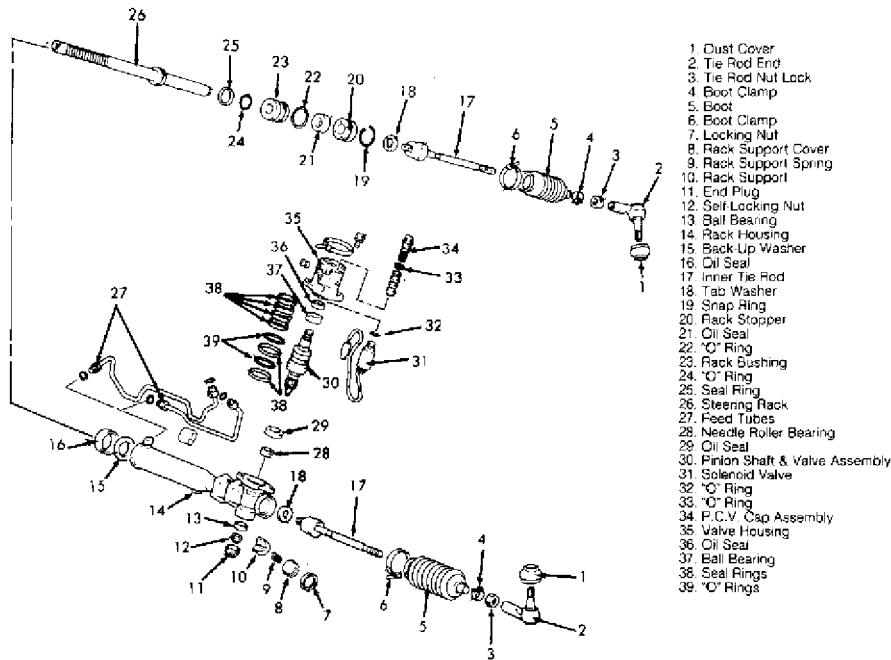

Fig. 5: Exploded View Of Electronic Power Rack & Pinion Assembly (Diamante & Galant With Electronic Power Steering)
Courtesy of Mitsubishi Motor Sales of America

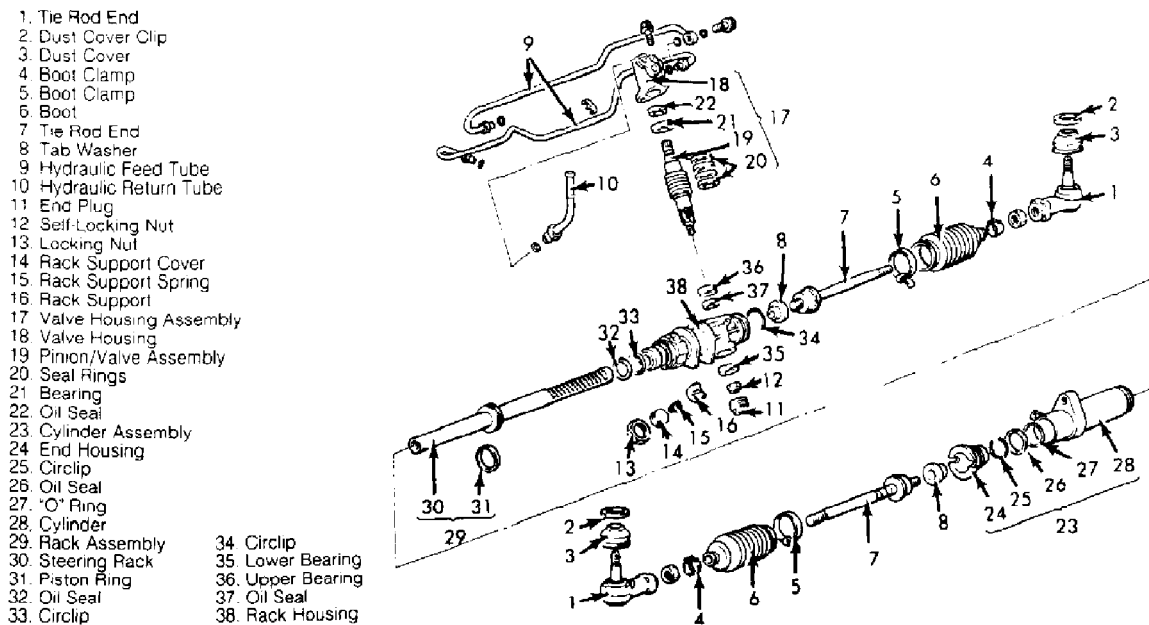

Fig. 6: Exploded View Of Power Rack & Pinion Assembly (Typical)
Courtesy of Chrysler Motors

WHEEL ALIGNMENT

After performing appropriate service procedures, refer to

STEERING SYSTEM - POWER

Article Text (p. 11)

1992 Mitsubishi Mirage

For a a a a

Copyright © 1998 Mitchell Repair Information Company, LLC

Monday, April 01, 2002 10:17AM

WHEEL ALIGNMENT SPECIFICATIONS & PROCEDURES article in the WHEEL ALIGNMENT section.

TORQUE SPECIFICATIONS

COLT, COLT 200 & SUMMIT

TORQUE SPECIFICATIONS (COLT, COLT 200 & SUMMIT)

Application	Ft. Lbs. (N.m)
Crossmember Bracket Bolt	56 (78)
Crossmember Bracket Nut	84-94 (110-130)
Crossmember Mounting Nut	84-94 (110-130)
Coupling-To-Pinion Shaft Joint Bolt	11-17 (15-23)
Power Cylinder Mounting Bolt	30 (42)
Power Steering Pump Cover Bolts	13-16 (18-22)
Power Steering Pump Mounting Bolts	18-24 (25-33)
Pressure Hose-To-Pump Nut	10-15 (14-21)
Rack Mounting Bolt	36-51 (50-70)
Strut Assembly Lower Mounting Bolt	72 (100)
Tie Rod End-To-Steering Knuckle	11-25 (15-34)
Tie Rod Lock Nut	25-36 (34-50)
Tie Rod-To-Rack	58-72 (80-100)

COLT VISTA, EXPO, MIRAGE & SUMMIT WAGON

TORQUE SPECIFICATIONS (COLT VISTA, EXPO, MIRAGE & SUMMIT WAGON)

Application	Ft. Lbs. (N.m)
Crossmember Bracket Bolt	56 (78)
Crossmember Bracket Nut	84-94 (110-130)
Crossmember Mounting Nut	84-94 (110-130)
Coupling-To-Pinion Shaft Joint Bolt	13 (18)
Power Cylinder Mounting Bolt	30 (42)
Power Steering Pump Cover Bolts	14 (20)
Power Steering Pump Mounting Bolts	29 (40)
Pressure Hose-To-Pump Nut	13 (18)
Rack Mounting Bolt	51 (70)
Rack Support Lock Nut	36-51 (50-70)
Strut Assembly Lower Mounting Bolt	72 (100)
Tie Rod End-To-Steering Knuckle	
Colt Vista & Summit Wagon	21 (29)
Expo	38 (53)
Tie Rod Lock Nut	
Colt Vista, Expo & Summit Wagon	38 (53)
Mirage	30 (42)
Tie Rod-To-Rack	65 (90)

STEERING SYSTEM - POWER

Article Text (p. 12)

1992 Mitsubishi Mirage

For a a a a

Copyright © 1998 Mitchell Repair Information Company, LLC

Monday, April 01, 2002 10:17AM

DIAMANTE

TORQUE SPECIFICATIONS (DIAMANTE)

Application	Ft. Lbs. (N.m)
Crossmember Bracket Bolt	56 (78)
Crossmember Bracket Nut	84-94 (110-130)
Crossmember Mounting Nut	84-94 (110-130)
Power Cylinder Mounting Bolt	30 (42)
Power Steering Pump Cover Bolts	16 (22)
Power Steering Pump Mounting Bolts	16 (22)
Pressure Hose-To-Pump Nut	17 (24)
Rack Mounting Bolt	51 (70)
Rack Support Lock Nut	36-51 (50-70)
Strut Assembly Lower Mounting Bolt	72 (100)
Tie Rod End-To-Steering Knuckle	36 (50)
Tie Rod Lock Nut	36-40 (50-54)
Tie Rod-To-Rack	65 (90)

ECLIPSE & GALANT

TORQUE SPECIFICATIONS (ECLIPSE & GALANT)

Application	Ft. Lbs. (N.m)
Crossmember Bracket Bolt	56 (78)
Crossmember Bracket Nut	84-94 (110-130)
Crossmember Mounting Nut	84-94 (110-130)
Coupling-To-Pinion Shaft Joint Bolt	11-14 (15-20)
Exhaust Pipe Nuts	22-29 (30-40)
Power Cylinder Mounting Bolt	30 (42)
Power Steering Pump Cover Bolts	13-16 (18-22)
Power Steering Pump Mounting Bolts	18-24 (25-33)
Pressure Hose-To-Pump Nut	10-15 (14-21)
Rack Mounting Bolt	43-58 (60-80)
Rack Support Lock Nut	36-51 (50-70)
Strut Assembly Lower Mounting Bolt	72 (100)
Tie Rod End-To-Steering Knuckle	17-25 (23-34)
Tie Rod Lock Nut	36-40 (50-54)
Tie Rod-To-Rack	58-72 (80-100)
Transfer Assembly Bolts	43-58 (60-80)

PRECIS

TORQUE SPECIFICATIONS (PRECIS)

Application	Ft. Lbs. (N.m)
Crossmember Bracket Bolt	56 (78)

STEERING SYSTEM - POWER

Article Text (p. 13)

1992 Mitsubishi Mirage

For a a a a

Copyright © 1998 Mitchell Repair Information Company, LLC

Monday, April 01, 2002 10:17AM

Crossmember Bracket Nut	84-94 (110-130)
Crossmember Mounting Nut	84-94 (110-130)
Coupling-To-Pinion Shaft Joint Bolt	11-14 (15-20)
Power Cylinder Mounting Bolt	30 (42)
Power Steering Pump Cover Bolts	24-31 (33-42)
Power Steering Pump Mounting Bolts	14 (20)
Pressure Hose-To-Pump Nut	12-17 (16-23)
Rack Mounting Bolt	43-58 (60-80)
Rack Support Lock Nut	36-51 (50-70)
Strut Assembly Lower Mounting Bolt	72 (100)
Tie Rod End-To-Steering Knuckle	11-25 (15-34)
Tie Rod Lock Nut	36-40 (50-54)
Tie Rod-To-Rack	58-72 (80-100)

STEALTH & 3000GT

TORQUE SPECIFICATIONS (STEALTH & 3000GT)

Application	Ft. Lbs. (N.m)
Crossmember Bracket Bolt	56 (78)
Crossmember Bracket Nut	84-94 (110-130)
Crossmember Mounting Nut	84-94 (110-130)
Coupling-To-Pinion Shaft Joint Bolt	13 (18)
Exhaust Pipe Nuts	36 (50)
Power Cylinder Mounting Bolt	30 (42)
Power Steering Pump Cover Bolts	14 (20)
Power Steering Pump Mounting Bolts	31 (43)
Pressure Hose-To-Pump Nut (Stealth)	17 (24)
Rack Mounting Bolt	51 (70)
Rack Support Lock Nut	36-51 (50-70)
Strut Assembly Lower Mounting Bolt	72 (100)
Tie Rod End-To-Steering Knuckle (Stealth)	36 (50)
Tie Rod Lock Nut	36-40 (50-54)
Tie Rod-To-Rack	65 (90)
Transfer Assembly Bolts	64 (88)

END OF ARTICLE